

# EYE HOOKS

## EYE HOOK EN1677-2

**GRADE 8 ACCESSORIES FOR CHAIN SLINGS**

standard: EN1677-2  
 surface finish: red painted  
 safety factor: 4:1  
 hook marking: \*manufacturer's code \*traceability code \*(WLLxx.xxT) \*grade number (chain size.8) \*CE  
 safety latch marking: \*chain size  
 usage: for chains slings and wire rope slings; for lifting purposes

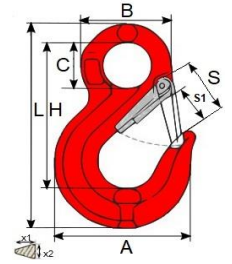

| code    | chain | WLL   | safety latch forged | A    | B    | C    | H    | L    | S    | S1   | X1   | X2   | weight   |
|---------|-------|-------|---------------------|------|------|------|------|------|------|------|------|------|----------|
|         | [mm]  | [T]   | [code]              | [mm] | [mm] | [mm] | [mm] | [mm] | [mm] | [mm] | [mm] | [mm] | [kg/pcs] |
| HLA0112 | 6     | 1,12  | HZH LA 0112         | 68   | 41   | 20   | 78   | 107  | 27   | 22   | 20   | 14   | 0,26     |
| HLA020  | 7-8   | 2,00  | HZH LA 020          | 77   | 48   | 25   | 98   | 131  | 34   | 27   | 23   | 18   | 0,46     |
| HLA0315 | 10    | 3,15  | HZH LA 0315         | 102  | 71   | 38   | 121  | 164  | 37   | 31   | 33   | 21   | 0,90     |
| HLA053  | 13    | 5,30  | HZH LA 053          | 131  | 83   | 43   | 151  | 212  | 51   | 40   | 44   | 27   | 2,05     |
| HLA080  | 16    | 8,00  | HZH LA 080          | 153  | 96   | 50   | 182  | 253  | 55   | 44   | 48   | 34   | 2,99     |
| HLA125  | 20    | 12,50 | HZH LA 125          | 195  | 119  | 62   | 215  | 300  | 61   | 52   | 59   | 44   | 5,87     |

## EYE HOOK DIN689

material: drop forged (carbon) steel, quenched and tempered  
 surface finish: galvanized  
 safety factor: 4:1  
 marking: \*code number (WLLxx.xxT) \*CE  
 safety latch: galvanized steel  
 usage: general use

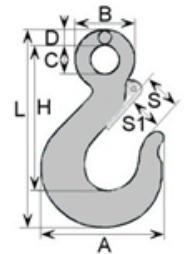

| code       | WLL  | A    | B    | C    | D    | H    | L    | S1   | S2   | weight   |
|------------|------|------|------|------|------|------|------|------|------|----------|
|            | [T]  | [mm] | [mm] | [mm] | [mm] | [mm] | [mm] | [mm] | [mm] | [kg/pcs] |
| HCDinZ0025 | 0,25 | 54   | 27   | 12   | 8    | 62   | 88   | 18   | 13   | 0,13     |
| HCDinZ005  | 0,50 | 71   | 36   | 15   | 10   | 83   | 118  | 24   | 21   | 0,32     |
| HCDinZ010  | 1,00 | 95   | 46   | 20   | 13   | 112  | 160  | 32   | 28   | 0,81     |

# SWIVEL HOOKS

## SWIVEL HOOK EN1677-2

**GRADE 8 ACCESSORIES FOR CHAIN SLINGS**

standard: EN1677-2  
 surface finish: red painted  
 safety factor: 4:1  
 marking: \*manufacturer's code \*traceability code \*(WLLxx.xxT) \*grade number (chain size.8) \*CE  
 safety latch: galvanized steel  
 usage: for chains slings and wire rope slings; for lifting purposes  
 caution: not rotate under load conditions

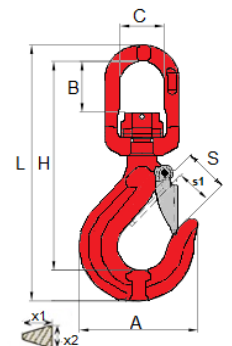

| code    | chain | WLL   | A    | B    | C    | H    | L    | S    | S1   | X1   | X2   | weight   |
|---------|-------|-------|------|------|------|------|------|------|------|------|------|----------|
|         | [mm]  | [T]   | [mm] | [mm] | [mm] | [mm] | [mm] | [mm] | [mm] | [mm] | [mm] | [kg/pcs] |
| HOA0112 | 6     | 1,12  | 69   | 26   | 31   | 112  | 139  | 25   | 21   | 18   | 16   | 0,38     |
| HOA020  | 7-8   | 2,00  | 89   | 39   | 43   | 150  | 185  | 28   | 24   | 25   | 20   | 0,99     |
| HOA0315 | 10    | 3,15  | 102  | 40   | 43   | 161  | 207  | 30   | 27   | 31   | 23   | 1,24     |
| HOA053  | 13    | 5,30  | 122  | 45   | 48   | 188  | 248  | 39   | 35   | 42   | 33   | 2,33     |
| HOA080  | 16    | 8,00  | 155  | 55   | 62   | 240  | 315  | 48   | 43   | 47   | 34   | 3,86     |
| HOA125  | 20    | 12,50 | 190  | 50   | 68   | 270  | 360  | 62   | 53   | 61   | 41   | 6,88     |

## CHAIN HOOKS

### CLEVIS HOOK EN1677-2

standard: EN1677-2  
 material: drop forged (alloy) steel, quenched and tempered  
 surface finish: red painted  
 safety factor: 4:1  
 hook marking: \*manufacturer's code \*traceability code \*(WLL.xx.xxT) \*grade number (chain size.8) \*CE  
 safety latch marking: \*chain size  
 usage: for chains slings; for lifting purposes

**GRADE 8 ACCESSORIES FOR CHAIN SLINGS**

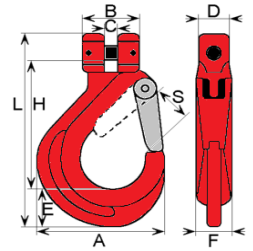

| code   | chain | WLL   | safety latch forged | A    | B    | C    | D    | E    | F    | H    | L    | S    | weight   |
|--------|-------|-------|---------------------|------|------|------|------|------|------|------|------|------|----------|
|        | [mm]  | [T]   | [code]              | [mm] | [mm] | [mm] | [mm] | [mm] | [mm] | [mm] | [mm] | [mm] | [kg/pcs] |
| HŁ0112 | 6     | 1,12  | HZHL 0112           | 73   | 31   | 8    | 23   | 21   | 14   | 76   | 110  | 23   | 0,31     |
| HŁ020  | 7-8   | 2,00  | HZHL 020            | 84   | 37   | 9    | 25   | 25   | 17   | 84   | 127  | 24   | 0,52     |
| HŁ0315 | 10    | 3,15  | HZHL 0315           | 99   | 49   | 13   | 28   | 30   | 26   | 101  | 154  | 30   | 1,00     |
| HŁ053  | 13    | 5,30  | HZHL 053            | 130  | 54   | 18   | 32   | 44   | 27   | 124  | 194  | 38   | 1,78     |
| HŁ080  | 16    | 8,00  | HZHL 080            | 160  | 69   | 22   | 38   | 59   | 34   | 145  | 235  | 48   | 3,55     |
| HŁ125  | 20    | 12,50 | HZHL 125            | 190  | 78   | 23   | 44   | 60   | 42   | 175  | 275  | 55   | 5,84     |

### CLEVIS HOOK EN1677-2

standard: EN1677-2  
 material: drop forged (alloy) steel, quenched and tempered  
 surface finish: blue painted  
 safety factor: 4:1  
 hook marking: \*manufacturer's code \*traceability code \*(WLL.xx.xxT) \*grade number (chain size.10) \*CE  
 safety latch marking: \*chain size  
 usage: for chains slings; for lifting purposes

**GRADE 10 ACCESSORIES FOR CHAIN SLINGS**

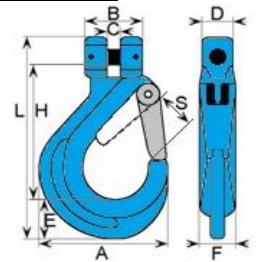

| code   | chain | WLL  | A     | B    | C    | D    | E    | F    | H    | L     | S    | weight   |
|--------|-------|------|-------|------|------|------|------|------|------|-------|------|----------|
|        | [mm]  | [T]  | [mm]  | [mm] | [mm] | [mm] | [mm] | [mm] | [mm] | [mm]  | [mm] | [kg/pcs] |
| XHŁ025 | 8     | 2,50 | 86,5  | 38   | 9    | 23,5 | 29,5 | 17   | 88   | 134   | 25   | 0,58     |
| XHŁ040 | 10    | 4,00 | 102,5 | 48   | 13   | 30   | 33,5 | 25   | 103  | 161,5 | 28   | 1,07     |
| XHŁ067 | 13    | 6,70 | 131,5 | 59   | 15   | 37   | 45   | 31   | 130  | 203   | 35   | 2,12     |

## SELF LOCKING HOOKS

### SELF LOCKING EYE HOOK EN1677-3

standard: EN1677-3  
 material: drop forged (alloy) steel, quenched and tempered  
 surface finish: red painted  
 safety factor: 4:1  
 marking: \*working load limit (WLL) \*grade number (chain size.8) \*CE  
 usage: for chains slings; for lifting purposes

**GRADE 8 ACCESSORIES FOR CHAIN SLINGS**

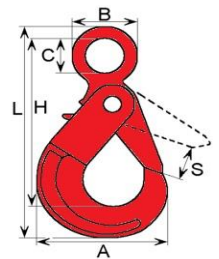

| code    | chain | WLL  | A    | B    | C    | H    | L    | S    | weight   |
|---------|-------|------|------|------|------|------|------|------|----------|
|         | [mm]  | [T]  | [mm] | [mm] | [mm] | [mm] | [mm] | [mm] | [kg/pcs] |
| HBA0112 | 6     | 1,12 | 70   | 44   | 22   | 108  | 140  | 37   | 0,48     |
| HBA020  | 7-8   | 2,00 | 86   | 49   | 25   | 130  | 165  | 45   | 0,82     |
| HBA0315 | 10    | 3,15 | 108  | 62   | 32   | 165  | 210  | 56   | 1,53     |
| HBA053  | 13    | 5,30 | 138  | 80   | 40   | 210  | 265  | 75   | 2,94     |
| HBA080  | 16    | 8,00 | 170  | 98   | 55   | 250  | 320  | 90   | 5,40     |

**SELF LOCKING CLEVIS HOOK EN1677-3**

**GRADE 8 ACCESSORIES FOR CHAIN SLINGS**

standard: EN1677-3  
 material: drop forged (alloy) steel, quenched and tempered  
 surface finish: red painted  
 safety factor: 4:1  
 marking: \*working load limit (WLL) \*grade number (chain size.8) \*CE  
 usage: for chains slings; for lifting purposes

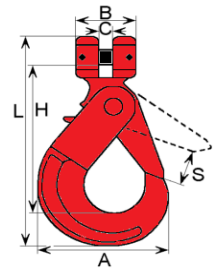

| code    | chain | WLL   | A    | B    | C    | H    | L    | S    | weight   |
|---------|-------|-------|------|------|------|------|------|------|----------|
|         | [mm]  | [T]   | [mm] | [mm] | [mm] | [mm] | [mm] | [mm] | [kg/pcs] |
| HBL0112 | 6     | 1,12  | 69   | 33   | 8    | 98   | 131  | 36   | 0,47     |
| HBL020  | 7-8   | 2,00  | 86   | 40   | 10   | 117  | 159  | 47   | 0,84     |
| HBL0315 | 10    | 3,15  | 104  | 45   | 13   | 140  | 195  | 56   | 1,48     |
| HBL053  | 13    | 5,30  | 133  | 58   | 16   | 175  | 244  | 66   | 2,85     |
| HBL080  | 16    | 8,00  | 170  | 78   | 19   | 220  | 300  | 66   | 6,00     |
| HBL125  | 20    | 12,50 | 195  | 80   | 23   | 230  | 330  | 67   | 8,17     |

**SELF LOCKING CLEVIS HOOK EN1677-3**

**GRADE 10 ACCESSORIES FOR CHAIN SLINGS**

standard: EN1677-3  
 material: drop forged (alloy) steel, quenched and tempered  
 surface finish: blue painted  
 safety factor: 4:1  
 marking: \*working load limit (WLL) \*grade number (chain size.10) \*CE  
 usage: for chains slings; for lifting purposes

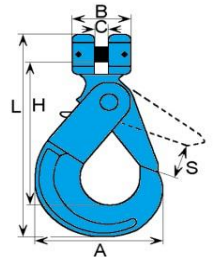

| code    | chain | WLL  | A    | B    | C    | H    | L    | S    | weight   |
|---------|-------|------|------|------|------|------|------|------|----------|
|         | [mm]  | [T]  | [mm] | [mm] | [mm] | [mm] | [mm] | [mm] | [kg/pcs] |
| XHBL025 | 8     | 2,50 | 90   | 36   | 10   | 119  | 160  | 40   | 0,85     |
| XHBL040 | 10    | 4,00 | 108  | 46   | 12   | 141  | 190  | 49   | 1,38     |
| XHBL067 | 13    | 6,70 | 137  | 59   | 15   | 182  | 251  | 66   | 2,90     |

**EYE GRAB HOOKS**

**EYE GRAB HOOK EN1677-1**

**GRADE 8 ACCESSORIES FOR CHAIN SLINGS**

standard: EN1677-1  
 material: drop forged (alloy) steel, quenched and tempered  
 surface finish: red painted  
 safety factor: 4:1  
 marking: \*manufacturer's code \*traceability code \*(WLL.xx.xxT) \*grade number (chain size.8) \*CE  
 usage: for chains slings; for lifting purposes

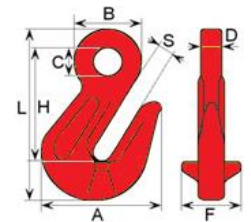

| code   | chain | WLL   | A    | B    | C    | D    | F    | H    | L    | S    | weight   |
|--------|-------|-------|------|------|------|------|------|------|------|------|----------|
|        | [mm]  | [T]   | [mm] | [mm] | [mm] | [mm] | [mm] | [mm] | [mm] | [mm] | [kg/pcs] |
| HS0112 | 6     | 1,12  | 46   | 30   | 14   | 8    | 20   | 46   | 73   | 8    | 0,14     |
| HS020  | 7-8   | 2,00  | 54   | 36   | 18   | 9    | 30   | 60   | 92   | 10   | 0,30     |
| HS0315 | 10    | 3,15  | 70   | 46   | 20   | 13   | 45   | 78   | 120  | 13   | 0,67     |
| HS053  | 13    | 5,30  | 94   | 56   | 26   | 15   | 55   | 99   | 155  | 16   | 1,36     |
| HS080  | 16    | 8,00  | 106  | 64   | 30   | 19   | 70   | 104  | 168  | 19   | 2,12     |
| HS125  | 20    | 12,50 | 133  | 83   | 38   | 23   | 73   | 135  | 215  | 23   | 4,10     |

**EYE GRAB HOOK EN1677-1**

**GRADE 10 ACCESSORIES FOR CHAIN SLINGS**

standard: EN1677-1  
 material: drop forged (alloy) steel, quenched and tempered  
 surface finish: blue painted  
 safety factor: 4:1  
 marking: \*manufacturer's code \*traceability code \*(WLL.xx.xxT) \*grade number (chain size.10) \*CE  
 usage: for chains slings; for lifting purposes

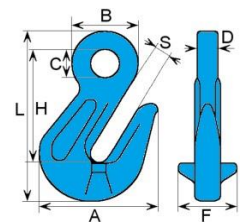

| code   | chain | WLL  | A    | B    | C    | D    | F    | H    | L    | S    | weight   |
|--------|-------|------|------|------|------|------|------|------|------|------|----------|
|        | [mm]  | [T]  | [mm] | [mm] | [mm] | [mm] | [mm] | [mm] | [mm] | [mm] | [kg/pcs] |
| XHS025 | 8     | 2,50 | 53   | 37   | 18   | 11   | 34   | 60   | 93   | 11   | 0,32     |
| XHS040 | 10    | 4,00 | 73   | 48   | 22   | 14   | 41   | 78   | 127  | 14   | 0,78     |
| XHS067 | 13    | 6,70 | 96   | 59   | 27   | 19   | 54   | 99   | 165  | 17   | 1,67     |

# SPECIAL HOOKS

## FOUNDRY EYE HOOK EN1677-1

**GRADE 8 ACCESSORIES FOR CHAIN SLINGS**

standard: EN1677-1  
 surface finish: red painted  
 safety factor: 4:1  
 marking: \*manufacturer's code \*traceability code \*(WLL.xx.xxT) \*grade number (chain size.8) \*CE  
 usage: for chains slings and wire rope slings; for lifting purposes

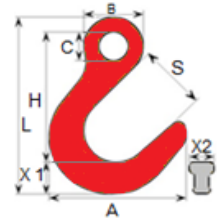

| code   | chain | WLL   | A    | B    | C    | H    | L    | S    | X1   | X2   | weight |
|--------|-------|-------|------|------|------|------|------|------|------|------|--------|
|        | [mm]  | [T]   | [mm] | [mm] | [mm] | [mm] | [mm] | [mm] | [mm] | [mm] |        |
| HK0112 | 6     | 1,12  | 99   | 42   | 21   | 101  | 133  | 48   | 23   | 16   | 0,32   |
| HK020  | 8     | 2,00  | 118  | 40   | 17   | 118  | 162  | 61   | 32   | 25   | 1,05   |
| HK032  | 10    | 3,20  | 145  | 50   | 22   | 145  | 192  | 75   | 38   | 33   | 2,02   |
| HK053  | 13    | 5,30  | 180  | 84   | 43   | 180  | 240  | 88   | 46   | 33   | 2,59   |
| HK080  | 16    | 8,00  | 205  | 95   | 48   | 210  | 275  | 102  | 50   | 38   | 4,09   |
| HK125  | 20    | 12,50 | 245  | 119  | 64   | 245  | 330  | 105  | 57   | 48   | 6,44   |

## FORESTRY CLEVIS HOOK EN 1677-1

**GRADE 8 ACCESSORIES FOR FORESTRY**

standard: EN1677-1  
 surface finish: red painted  
 safety factor: 4:1  
 marking: \*manufacturer's code \*traceability code \*(WLL.xx.xxT) \*grade number (chain size.8) \*CE  
 usage: for forestry

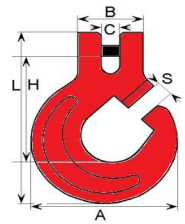

| code   | chain | WLL  | A    | B    | C    | H    | L    | S    | weight |
|--------|-------|------|------|------|------|------|------|------|--------|
|        | [mm]  | [T]  | [mm] | [mm] | [mm] | [mm] | [mm] | [mm] |        |
| HF020  | 7-8   | 2,00 | 71   | 34   | 9,5  | 57   | 94   | 11   | 0,36   |
| HF0315 | 10    | 3,15 | 97   | 44   | 13   | 80   | 135  | 12,5 | 0,90   |
| HF053  | 13    | 5,30 | 117  | 53   | 17   | 94   | 160  | 15   | 1,84   |

## SLIDING CHOKER HOOK EN 1677-2

**GRADE 8 ACCESSORIES FOR STEEL ROPES**

standard: EN1677-2  
 surface finish: red painted  
 safety factor: 4:1  
 marking: \*manufacturer's code \*traceability code \*(WLL.xx.xxT) \*grade number (chain size.8) \*CE  
 usage: for moving (sliding) on steel ropes

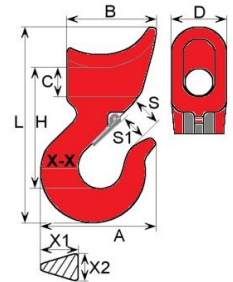

| code  | steel rope | WLL  | A    | B    | C    | D    | H    | L    | S    | S1   | X1   | X2   | weight |
|-------|------------|------|------|------|------|------|------|------|------|------|------|------|--------|
|       | [mm]       | [T]  | [mm] | [mm] | [mm] | [mm] | [mm] | [mm] | [mm] | [mm] | [mm] | [mm] |        |
| HP016 | 10-13      | 1,60 | 70   | 50   | 17   | 31   | 74   | 131  | 25   | 19   | 25   | 18   | 0,70   |
| HP020 | 14-16      | 2,00 | 78   | 62   | 22   | 42   | 80   | 150  | 28   | 22   | 28   | 20   | 1,10   |
| HP030 | 18-20      | 3,00 | 100  | 68   | 27   | 50   | 83   | 170  | 38   | 28   | 31   | 25   | 1,86   |
| HP050 | 22-25      | 5,00 | 130  | 83   | 32   | 62   | 110  | 210  | 45   | 37   | 42   | 33   | 4,20   |

# SAFETY LATCHES FOR HOOKS

## SAFETY LATCH FOR HOOKS HLAxxx

material: forged steel  
 surface finish: galvanized  
 usage: for hooks HLAxxx

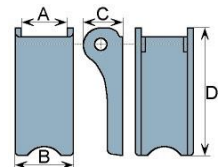

| code      | for hooks         | A    | B    | C    | D    | weight |
|-----------|-------------------|------|------|------|------|--------|
|           |                   | [mm] | [mm] | [mm] | [mm] |        |
| HZHLA0112 | HLA0112, HOA0112  | 13,5 | 20   | 12   | 43   | 0,030  |
| HZHLA020  | HLA020            | 16   | 21   | 15   | 57   | 0,045  |
| HZHLA0315 | HLA0315           | 16   | 16   | 15   | 57   | 0,055  |
| HZHLA053  | HLA053            | 21   | 30   | 20   | 68   | 0,091  |
| HZHLA080  | HLA080, HCDinZ025 | 26   | 29   | 24   | 85   | 0,126  |
| HZHLA125  | HLA125            | 27   | 37   | 23   | 84   | 0,190  |

## SAFETY LATCH FOR HOOKS HŁxxx

material: forged steel  
 surface finish: galvanized  
 usage: for hooks HŁxxx

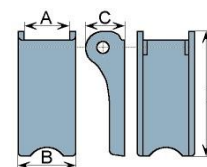

| code     | for hooks | A    | B    | C    | D    | weight |
|----------|-----------|------|------|------|------|--------|
|          |           | [mm] | [mm] | [mm] | [mm] |        |
| HZHŁ0112 | HŁ0112    | 14   | 20   | 12   | 43   | 0,030  |
| HZHŁ020  | HŁ020     | 15   | 22   | 15   | 52   | 0,045  |
| HZHŁ0315 | HŁ0315    | 18   | 25   | 17   | 63   | 0,062  |
| HZHŁ053  | HŁ053     | 22   | 25   | 21   | 78   | 0,126  |
| HZHŁ080  | HŁ080     | 27   | 29   | 24   | 84   | 0,136  |
| HZHŁ125  | HŁ125     | 28   | 36   | 25   | 95   | 0,220  |

## SPARE PART KIT FOR HOOKS HBŁxxx

material: forged steel  
 surface finish: galvanized  
 usage: for hooks HBŁxxx

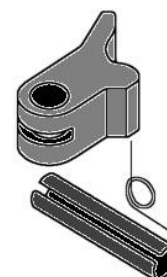

| code      | for hooks | weight   |
|-----------|-----------|----------|
|           |           | [kg/pcs] |
| HZHBL0112 | HBŁ0112   | 0,020    |
| HZHBL020  | HBŁ020    | 0,040    |
| HZHBL0315 | HBŁ0315   | 0,050    |
| HZHBL053  | HBŁ053    | 0,110    |
| HZHBL080  | HBŁ080    | 0,130    |
| HZHBL125  | HBŁ125    | 0,160    |